

**MONTREUX**  
All Ages

**FREELAND 2**

**Square Footage**

1,430 Sq. Ft.

GARAGE,  
FRONT PORCH,  
COVERED BACK PATIO

**Bedrooms**

MASTER SUITE, 2 BEDROOMS

**Bathrooms**

2 BATHROOMS

**Other Rooms**

LIVING ROOM, DINING ROOM

**Other Features**

LIVING ROOM WITH  
VAULTED CEILING AND  
GAS FIREPLACE

BREAKFAST ISLAND IN  
KITCHEN

LARGE COVERED DECKS  
MASTER SUITE

**Architecture**

SINGLE STORY  
NW CRAFTSMAN STYLE

**Garage**

2 CAR

INSULATED WITH  
FINISHED DRYWALL

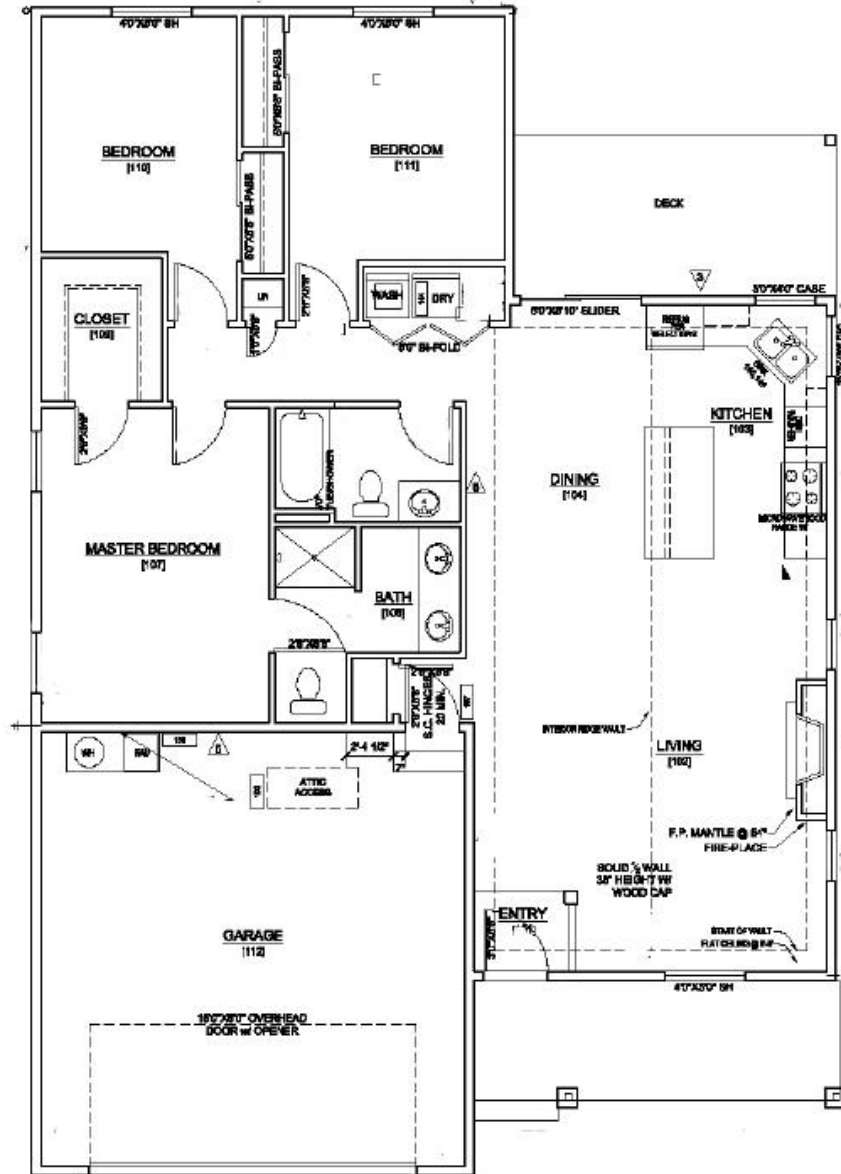

Floorplan and elevation shown are for illustration purposes only. Colors and sizes are approximate. Builder reserves the right to revise floorplans and elevations as deemed necessary.